

Setting Up Canvas Parent Observer Account

Essentially parents will be making an account to link with their student's account. This will require them to log in as well as the student (either at separate times OR on separate devices).

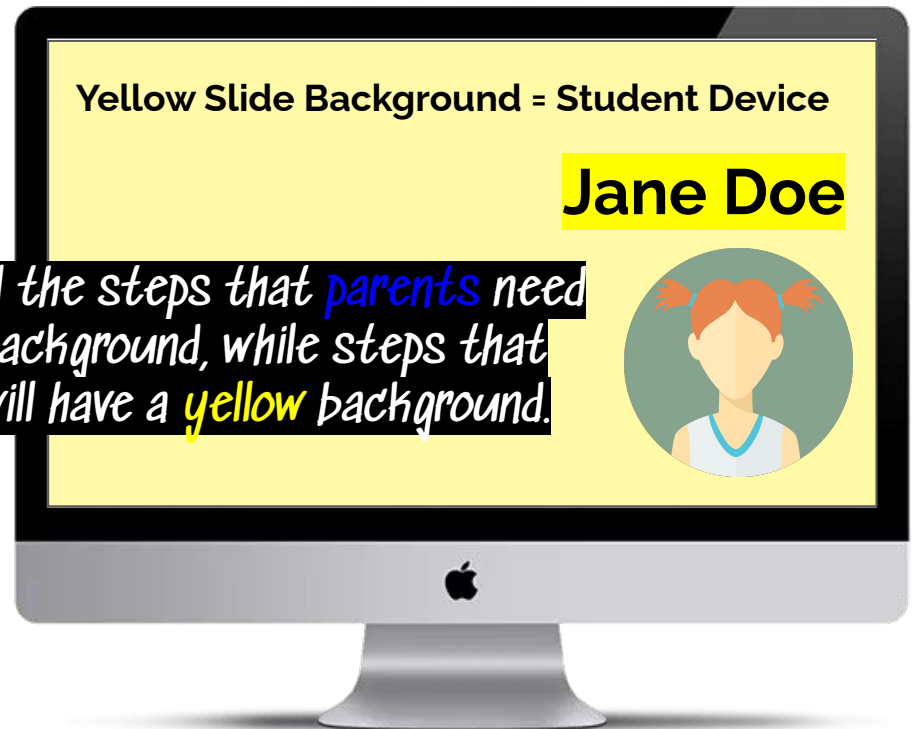
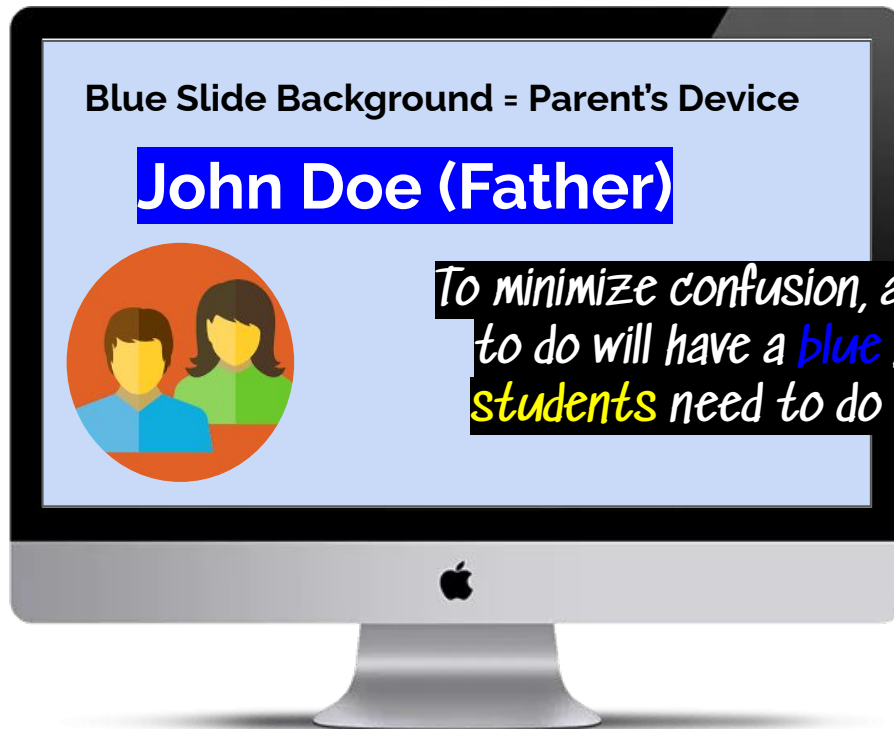

Step 1: Getting the Student's Pairing Code

Students, log into canvas normally by going here:

Note: the student login link is slightly different than the parent login page

<https://slcschools.instructure.com/>



Jane Doe

Students, if your name was Jane Doe and your Student ID was 123456, then your email would be jane.d456@slcstudents.org
Your password is the one you use for all school computers and Powerschool

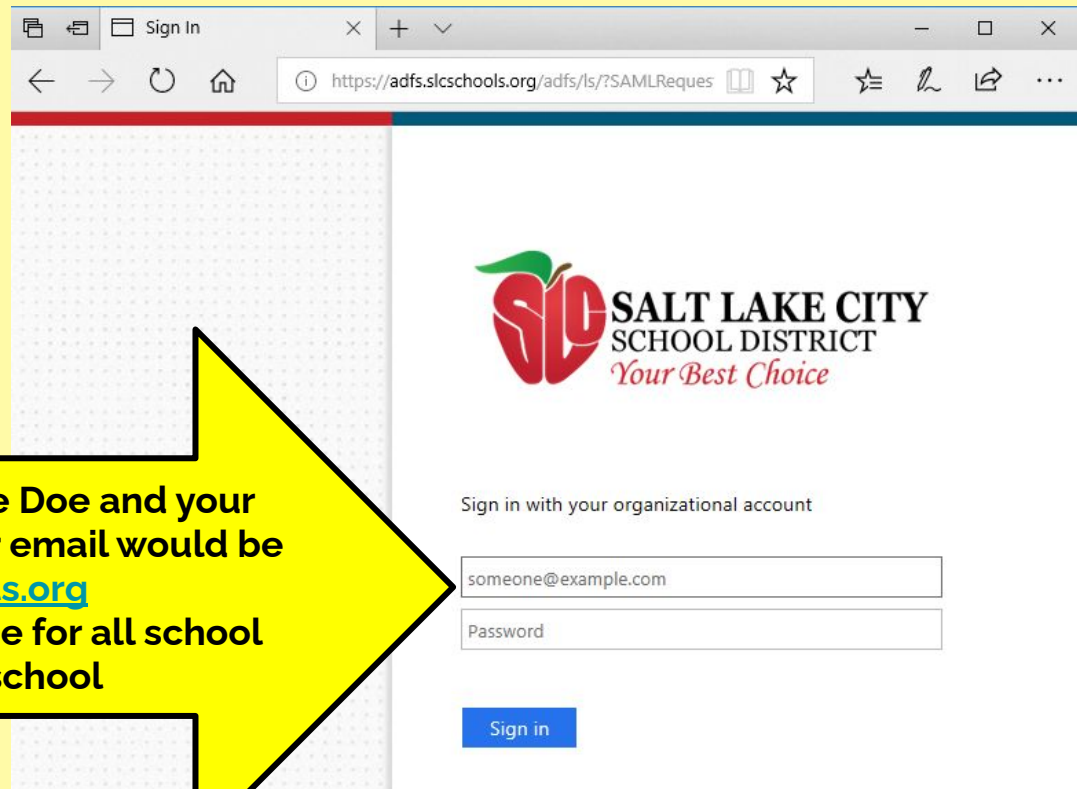

Sign in with your organizational account

someone@example.com

Password

Sign in

Step 2: Getting the Student's Pairing Code

<https://slcschools.instructure.com/>

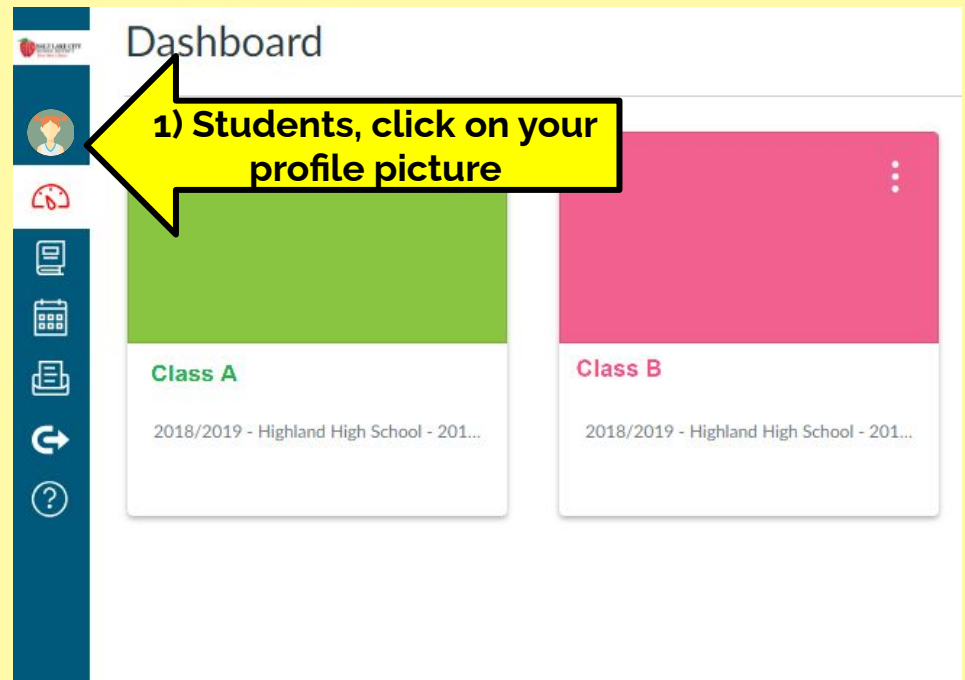
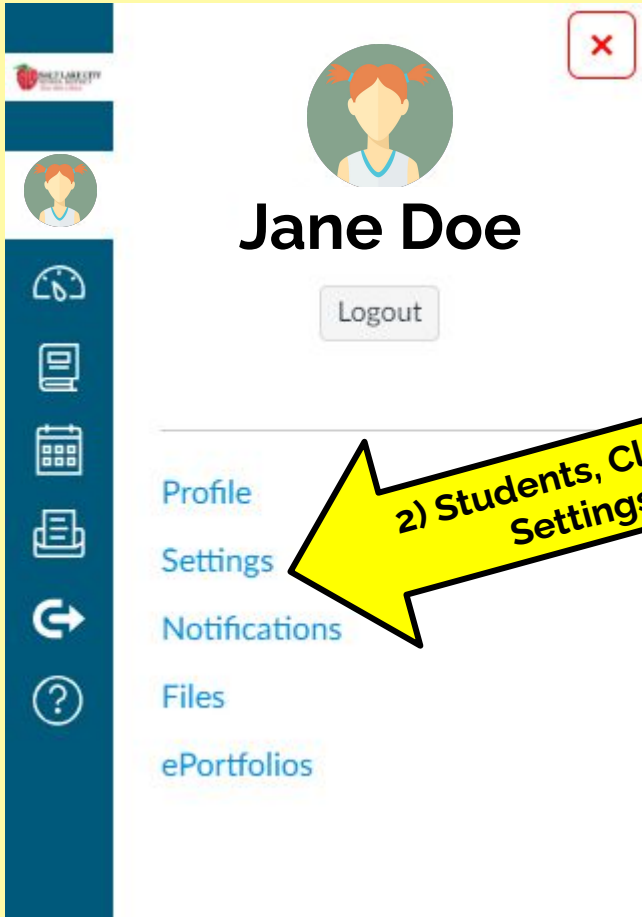

Step 2: Getting the Student's Pairing Code

<https://slcschools.instructure.com/>

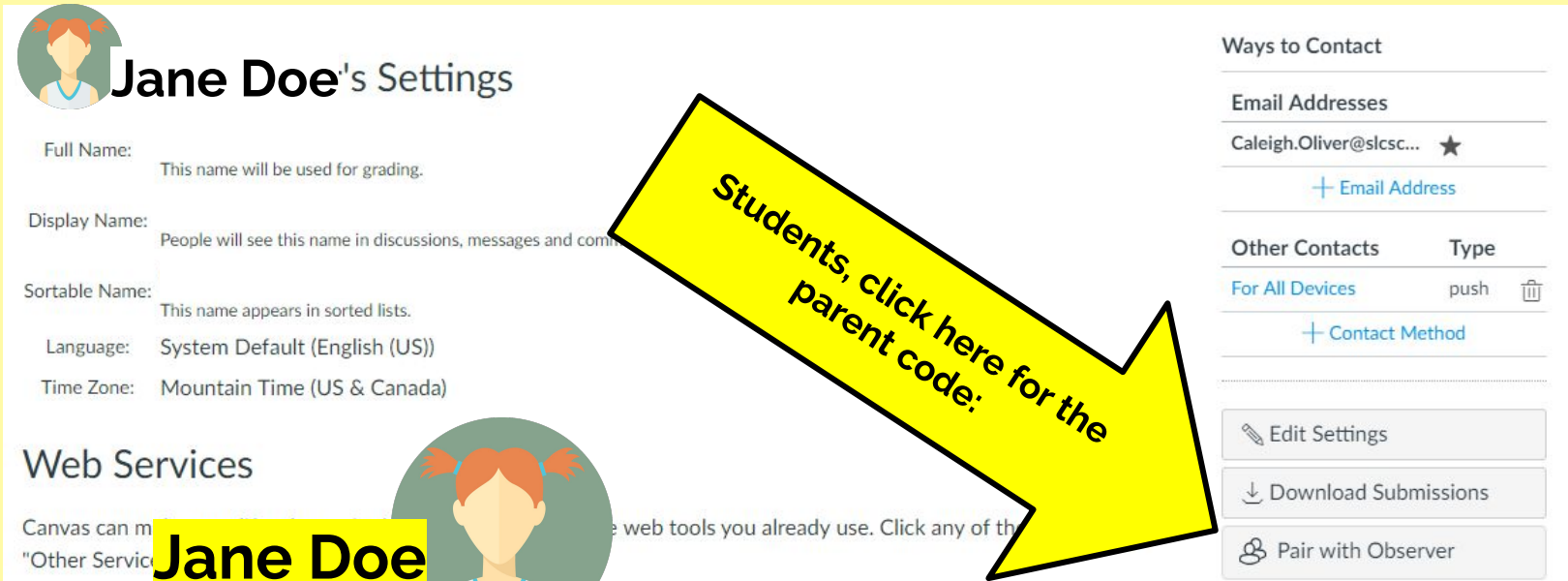

Jane Doe's Settings

Full Name: This name will be used for grading.

Display Name: People will see this name in discussions, messages and comments.

Sortable Name: This name appears in sorted lists.

Language: System Default (English (US))

Time Zone: Mountain Time (US & Canada)

Web Services

Canvas can make it easier to use the web tools you already use. Click any of the following to connect your account.

Other Services

Ways to Contact

Email Addresses

Caleigh.Oliver@slcsc... ★

+ Email Address

Other Contacts	Type
For All Devices	push

+ Contact Method

Edit Settings

Download Submissions

Pair with Observer

Students, click here for the parent code:

Jane Doe

Students, this is your temporary pairing code!

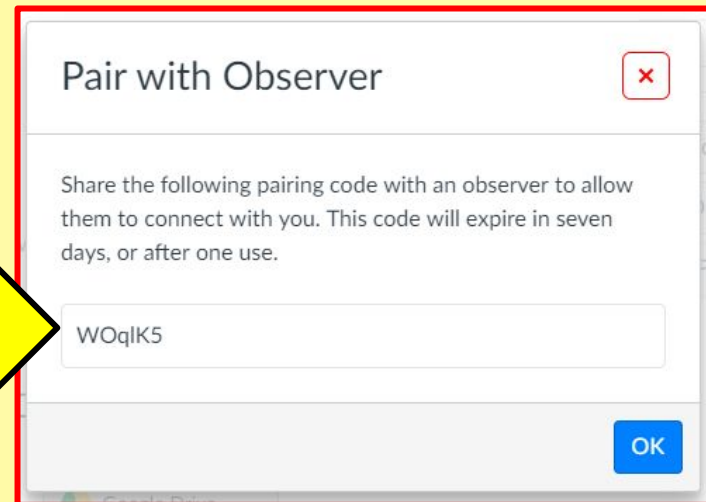

Pair with Observer

Share the following pairing code with an observer to allow them to connect with you. This code will expire in seven days, or after one use.

WOqIK5

OK

Step 3: District Canvas Page

Parents go to:

<https://slcschools.instructure.com/login/ldap>

SALT LAKE CITY SCHOOL DISTRICT
Your Best Choice

Parent of a Canvas User?
[Click Here For an Account](#)

John Doe

Login

Password

Stay signed in

[Forgot Password?](#)

Log In

[Help](#) [Privacy policy](#) [Acceptable Use Policy](#) [Facebook](#) [Twitter](#)

INSTRUCTURE

Step 4: Account Creation

<https://slcschools.instructure.com/login/ldap>

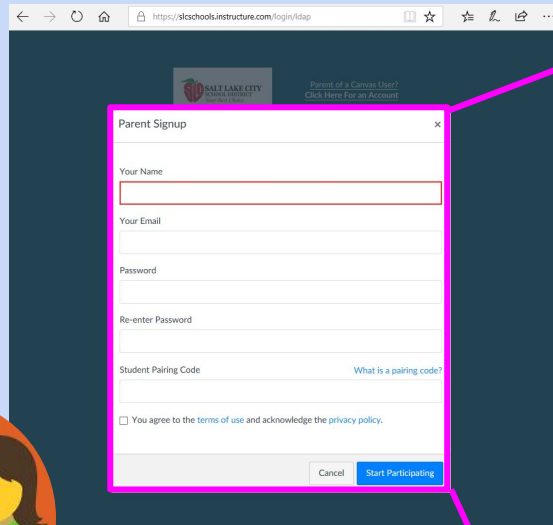

John Doe

Parent Signup

Your Name
John Doe

Your Email
 johndoeexample@email.com

Password
Parent Password (Create)

Re-enter Password
Parent Password (Confirm)

Student Pairing Code [What is a pairing code?](#)

You agree to the [terms of use](#) and acknowledge the [privacy policy](#).

Cancel Start Participating

What is this???
(See next slide)

**Parents, get this
from your student!**

Step 5: Enter Student Code

<https://slcschools.instructure.com/login/ldap>

Pair with Observer

Share the following pairing code with an observer to allow them to connect with you. This code will expire in seven days, or after one use.

WOqIK5

OK

1) Parents, enter the student code here



John Doe

Parent Signup

Your Name
John Doe

Your Email
johndoeexample@email.com

Password
Parent Password (Create)

Re-enter Password
Parent Password (Confirm)

Student Pairing Code
WOqIK5

You agree to the [terms of use](#) and acknowledge the [privacy policy](#).

Start Participating

2) Parents, click 'start participating'

Step 6: Parent Login Portal

Parents go to:

<https://slcschools.instructure.com/login/ldap>

Log In to Canvas

<https://slcschools.instructure.com/login/ldap>

 SALT LAKE CITY SCHOOL DISTRICT
Your Best Choice

Parent of a Canvas User?
[Click Here For an Account](#)

Parent of a Canvas User?
NOT HERE

Login

Password

Stay signed in

[Forgot Password?](#)

[Help](#) [Privacy policy](#) [Acceptable Use Policy](#) [Facebook](#) [Twitter](#)

INSTRUCTURE

Parents, when you log in after the initial setup, enter email and password here



John Doe